



Datasheet

Model Number : TMT182SM

DC~18GHz, 2W, SMA Male Coaxial Termination

Specifications

Frequency Range	DC-18GHz
Input Avg Power	2W@25deg. C
Peak Power	250W (5μsec pulse width, 0.4%duty cycle)
VSWR	1.3 max.
Impedance	50 Ohms
Connector	SMA Male
Connector Body	Passivated stainless steel
Center Contact	Gold plated brass
Operating Temperature	-55~+100deg. C
Storage Temperature	-55~+125deg. C
Heat Sink	N/A
RoHS Status	RoHS Compliant

Dimensions[mm]:

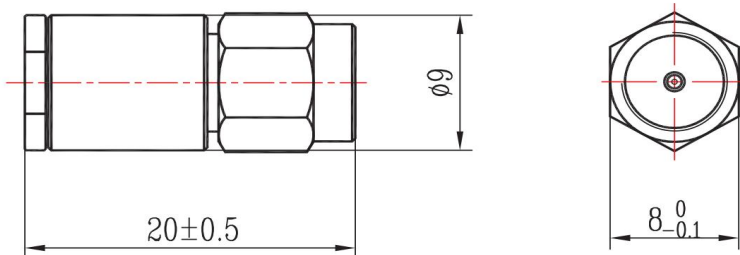

Typical Test Curve

Trc1 **S11** SWR 100 mU/ Ref 1.3 U Cal Smo 1

