

FEATURES

- Small Size
- High Accuracy
- High Stability
- Rugged Design

APPLICATIONS

- Wireless Communication
- Laboratory Test



Electrical Specifications

Frequency Range	0.9~4GHz
Bandwidth	100MHz & 200MHz
Attenuation Range	0~10dB & 0~25dB
Attenuation Accuracy	±0.5dB
VSWR	1.5 max.
Insertion Loss	1.0dB max.
Impedance	50 Ohms
Average Power	300 Watts

Mechanical Specifications

Connector	N female to N female
Connector Material	Brass Nickel Plated
Female Pin	Beryllium Copper, Gold Plated
Housing	Aluminum, Black Anodized
Temperature Range	-40°C ~ +65°C
Weight	2.6kg
Size	259×102×75mm
RoHS Status	RoHS Compliant

Ordering Information

300WVA	259102	-	10	-	2700	-	2900	-	N
				RF Connector					
				N:N female to N female					
				Max Frequency(MHz)					
				Min Frequency(MHz)					
				Max Attenuation Value(dB)					
				Attenuator Dimensions(mm)					
300W Variable Attenuator									

Outline Drawings[mm]

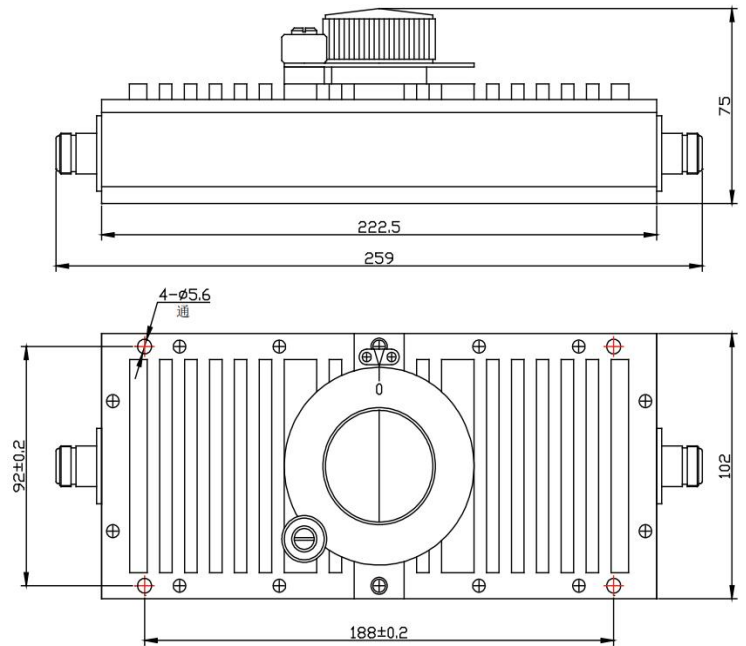

* 300WVA259102 becomes:
 300WVA259102-10-2700-2900-N when start frequency is 2700MHz, bandwidth 200MHz and attenuation range 0~10dB.
 * 300WVA259102 becomes:
 300WVA259102-25-1000-1100-N when start frequency is 1000MHz, bandwidth 100MHz and attenuation range 0~25dB.