

FEATURES

- Small Size
- High Accuracy
- High Stability
- Rugged Design

APPLICATIONS

- Wireless Communication
- Laboratory Test



Electrical Specifications

Frequency Range	DC~2.5GHz
Attenuation Range/Steps	0~1dB in 0.1dB steps
Attenuation Accuracy	±0.2dB
VSWR	1.25 max.
Insertion Loss	0.5 max.
Impedance	50 Ohms
Average Power	2W or 10W
Peak Power	100 Watts (5μs pulse width, 2% duty cycle)

Mechanical Specifications

Connector	SMA or N
Connector Material	Brass Nickel Plated
Female Pin	Beryllium Copper, Gold Plated
Housing	Aluminum, Brass Nickel Plated
Temperature Range	-20°C ~ +85°C
Weight	250g
Size	63×Ø30mm exclusive of connectors
RoHS Status	RoHS Compliant

Ordering Information

XW	SA	6330	-	2.5	-	1	-	Y
Average Power ▷ options: 2W, 10W								
Step Attenuator								
Attenuator Dimensions(mm)								
Max Frequency(GHz)								
Max Attenuation Value(dB)								
RF Connector								
S: SMA female to SMA female								
N: N female to N female								

Outline Drawings[mm]

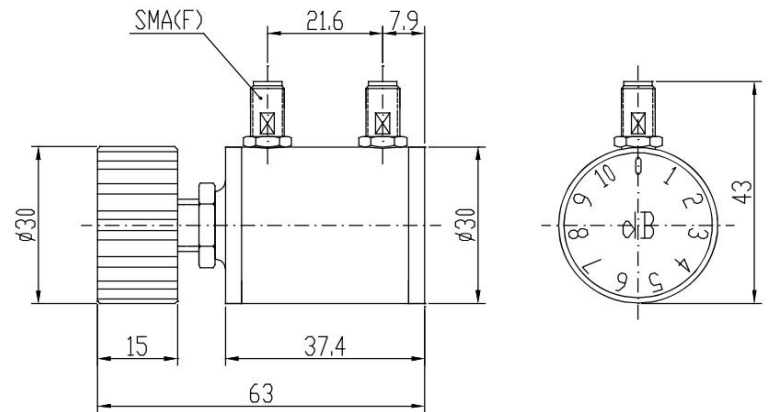

* XWSA6330-2.5-1-Y becomes:
10WSA6330-2.5-1-N, when frequency range DC~2.5GHz, 0~1dB attenuation range in 0.1dB steps, average power 10W, N connectors, are desired.

* XWSA6330-2.5-1-Y becomes:
2WSA6330-2.5-1-S, when frequency range DC~2.5GHz, 0~1dB attenuation range in 0.1dB steps, average power 2W, SMA connectors, are desired.