

## FEATURES

- ❑ Small Size
- ❑ High Accuracy
- ❑ High Stability
- ❑ Rugged Design

## APPLICATIONS

- ❑ Wireless Communication
- ❑ Laboratory Test



## Electrical Specifications

|                         |   |
|-------------------------|---|
| Frequency Range         | DC~6GHz                                       |
| Attenuation Range/Steps | 0~1dB in 0.1dB steps                          |
| Attenuation Accuracy    | ±0.3dB  |
| VSWR                    | 1.4 max.                                      |
| Insertion Loss          | 1.0 max.                                      |
| Impedance               | 50 Ohms                                       |
| Average Power           | 2W or 10W                                     |
| Peak Power              | 100 Watts<br>(5μs pulse width, 2% duty cycle) |

## Mechanical Specifications

|                    |                                  |
|--------------------|----------------------------------|
| Connector          | SMA or N                         |
| Connector Material | Brass Nickel Plated              |
| Female Pin         | Beryllium Copper, Gold Plated    |
| Housing            | Aluminum, Brass Nickel Plated    |
| Temperature Range  | -20°C ~ +85°C                    |
| Weight             | 250g                             |
| Size               | 63×Ø30mm exclusive of connectors |
| RoHS Status        | RoHS Compliant                   |

## Ordering Information

|   |           |             |          |          |          |          |          |          |
|---|-----------|-------------|----------|----------|----------|----------|----------|----------|
| <b>XW</b>   | <b>SA</b> | <b>6330</b> | <b>-</b> | <b>6</b> | <b>-</b> | <b>1</b> | <b>-</b> | <b>Y</b> |
| Step Attenuator<br>Attenuator Dimensions(mm)<br>Max Frequency(GHz)<br>Max Attenuation Value(dB)<br>RF Connector<br>S: SMA female to SMA female<br>N: N female to N female<br>Average Power ▷ options: 2W, 10W |           |             |          |          |          |          |          |          |

## Outline Drawings[mm]

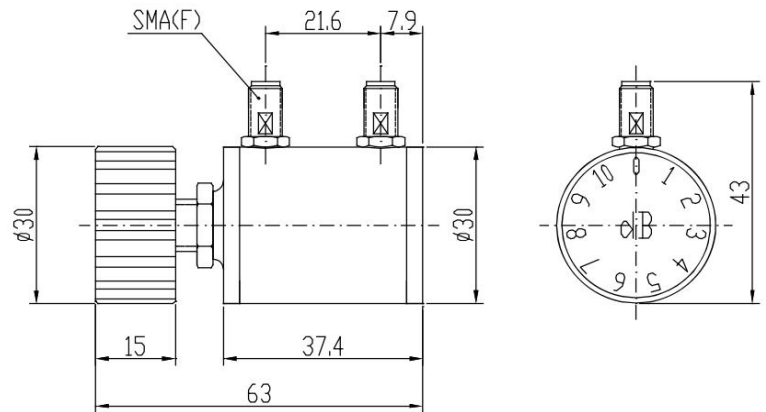

- \* XWSA6330-6-1-Y becomes:  
 10WSA6330-6-1-N, when frequency range DC~6GHz, 0~1dB attenuation range in 0.1dB steps, average power 10W, N connectors, are desired.
- \* XWSA6330-6-1-Y becomes:  
 2WSA6330-6-1-S, when frequency range DC~6GHz, 0~1dB attenuation range in 0.1dB steps, average power 2W, SMA connectors, are desired.