

FEATURES

- Small Size
- High Accuracy
- High Stability
- Rugged Design

APPLICATIONS

- Wireless Communication
- Laboratory Test



Electrical Specifications

Frequency Range	DC~6GHz
Attenuation Range/Steps	0~10dB in 1dB steps
Attenuation Accuracy	±0.5dB
VSWR	1.4 max.
Insertion Loss	1.0 max.
Impedance	50 Ohms
Average Power	2W or 10W
Peak Power	100 Watts (5μs pulse width, 2% duty cycle)

Mechanical Specifications

Connector	SMA or N
Connector Material	Brass Nickel Plated
Female Pin	Beryllium Copper, Gold Plated
Housing	Aluminum, Brass Nickel Plated
Temperature Range	-20°C ~ +85°C
Weight	250g
Size	63×Ø30mm exclusive of connectors
RoHS Status	RoHS Compliant

Ordering Information

XW	SA	6330	-	6	-	10	-	Y
Step Attenuator Attenuator Dimensions(mm) Max Frequency(GHz) Max Attenuation Value(dB) RF Connector S: SMA female to SMA female N: N female to N female Average Power ▷ options: 2W, 10W								

Outline Drawings[mm]

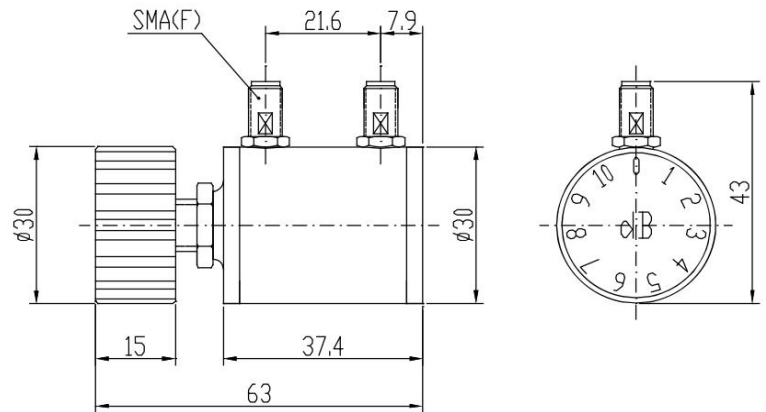

- * XWSA6330-6-10-Y becomes:
 10WSA6330-6-10-N, when frequency range DC~6GHz, 0~10dB attenuation range in 1dB steps, average power 10W, N connectors, are desired.
- * XWSA6330-6-10-Y becomes:
 2WSA6330-6-10-S, when frequency range DC~6GHz, 0~10dB attenuation range in 1dB steps, average power 2W, SMA connectors, are desired.