

FEATURES

- ❑ Small Size
- ❑ High Accuracy
- ❑ High Stability
- ❑ Rugged Design

APPLICATIONS

- ❑ Wireless Communication
- ❑ Laboratory Test



Electrical Specifications

Frequency Range	DC~3GHz
Attenuation Range/Steps	0~90dB in 10dB steps
Attenuation Accuracy	±0.5dB (Att. < 50dB) ±3.5% (Att. ≥ 50dB)
VSWR	1.3 max.
Insertion Loss	0.5 max.
Impedance	50 Ohms
Average Power	2W or 10W
Peak Power	100 Watts (5μs pulse width, 2% duty cycle)

Mechanical Specifications

Connector	SMA or N
Connector Material	Brass Nickel Plated
Female Pin	Beryllium Copper, Gold Plated
Housing	Aluminum, Brass Nickel Plated
Temperature Range	-20°C ~ +85°C
Weight	250g
Size	63×Ø30mm exclusive of connectors
RoHS Status	RoHS Compliant

Ordering Information

XW	SA	6330	-	3	-	90	-	Y
Average Power ▷ options: 2W, 10W								
Step Attenuator								
Attenuator Dimensions(mm)								
Max Frequency(GHz)								
Max Attenuation Value(dB)								
RF Connector								
S: SMA female to SMA female								
N: N female to N female								

Outline Drawings[mm]

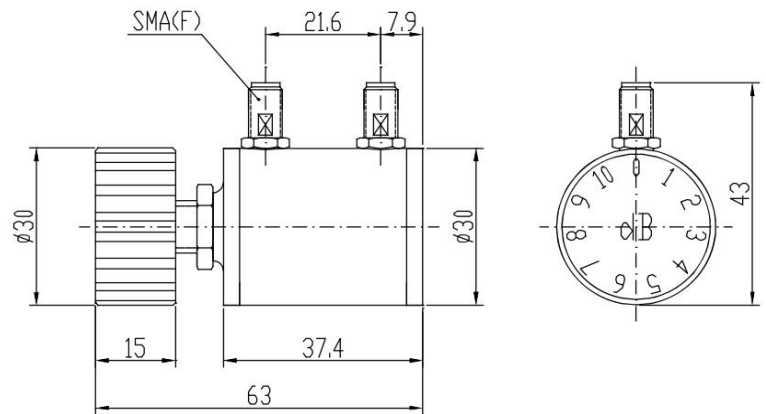

- * XWSA6330-3-90-Y becomes:
10WSA6330-3-90-N, when frequency range DC~3GHz, 0~90dB attenuation range in 10dB steps, average power 10W, N connectors, are desired.
- * XWSA6330-3-90-Y becomes:
2WSA6330-3-90-S, when frequency range DC~3GHz, 0~90dB attenuation range in 10dB steps, average power 2W, SMA connectors, are desired.