

FEATURES

- Small Size
- High Accuracy
- High Stability
- Rugged Design

APPLICATIONS

- Wireless Communication
- Laboratory Test



Electrical Specifications

Frequency Range	DC~2.5GHz
Attenuation Range/Steps	0~70dB in 1dB steps
Attenuation Accuracy(dB)	±0.5 (Att. ≤10dB) ±0.8 (10dB < Att. < 60dB) ±1.5 (Att. ≥60dB)
VSWR	SMA: 1.3 max / N: 1.45 max
Insertion Loss	1.0 max.
Impedance	50 Ohms
Average Power	2W or 10W
Peak Power	100 Watts (5μs pulse width, 2% duty cycle)

Outline Drawings[mm]

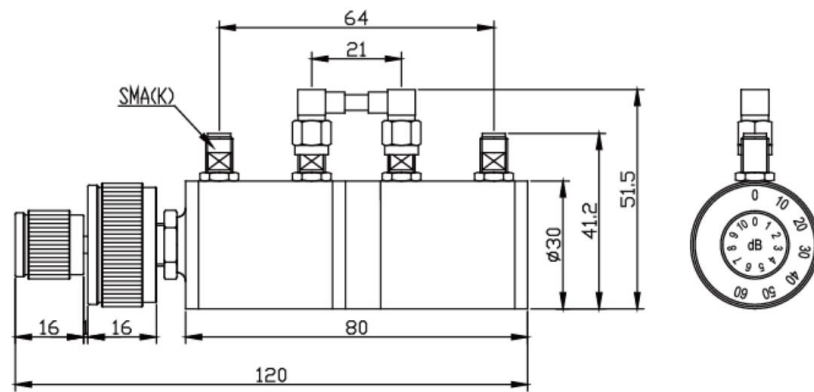

Mechanical Specifications

Connector	SMA or N
Connector Material	Brass Nickel Plated
Female Pin	Beryllium Copper, Gold Plated
Housing	Aluminum, Brass Nickel Plated
Temperature Range	-20°C ~ +85°C
Weight	435g
Size	120×Ø30mm exclusive of connectors
RoHS Status	RoHS Compliant

Ordering Information

XW	SA	12030	-	2.5	-	70	-	Y
Step Attenuator								
		Attenuator Dimensions(mm)			Max Frequency(GHz)		Max Attenuation Value(dB)	
		RF Connector		S: SMA female to SMA female N: N female to N female				
Average Power ▷ options: 2W, 10W								

- * XWSA12030-2.5-70-Y becomes: **10WSA12030-2.5-70-N** when frequency range DC~2.5GHz, 0~70dB attenuation range in 1dB steps, average power 10W, N connectors, are desired.
- * XWSA12030-2.5-70-Y becomes: **2WSA12030-2.5-70-S** when frequency range DC~2.5GHz, 0~70dB attenuation range in 1dB steps, average power 2W, SMA connectors, are desired.