

FEATURES

- ❑ Small Size
- ❑ High Accuracy
- ❑ High Stability
- ❑ Rugged Design

APPLICATIONS

- ❑ Wireless Communication
- ❑ Laboratory Test



Electrical Specifications

Frequency Range	DC~3GHz
Attenuation Range/Steps	0~70dB in 1dB steps
Attenuation Accuracy(dB)	±0.5 (Att. ≤10dB) ±0.8 (10dB<Att.<60dB) ±1.5 (Att. ≥60dB)
VSWR	SMA: 1.35 max / N: 1.45 max
Insertion Loss	1.2 max.
Impedance	50 Ohms
Average Power	2W or 10W
Peak Power	100 Watts (5μs pulse width, 2% duty cycle)

Outline Drawings[mm]

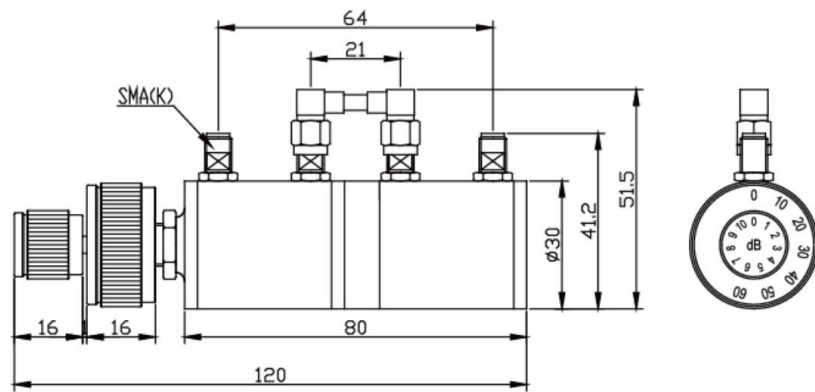

Mechanical Specifications

Connector	SMA or N
Connector Material	Brass Nickel Plated
Female Pin	Beryllium Copper, Gold Plated
Housing	Aluminum, Brass Nickel Plated
Temperature Range	-20°C ~ +85°C
Weight	435g
Size	120×Ø30mm exclusive of connectors
RoHS Status	RoHS Compliant

Ordering Information

XW	SA	12030	-	3	-	70	-	Y
Average Power ▷ options: 2W, 10W								
Step Attenuator								
Attenuator Dimensions(mm)								
Max Frequency(GHz)								
Max Attenuation Value(dB)								
RF Connector								
S: SMA female to SMA female								
N: N female to N female								

* XWSA12030-3-70-Y becomes:
10WSA12030-3-70-N when frequency range DC~3GHz, 0~70dB attenuation range in 1dB steps, average power 10W, N connectors, are desired.
 * XWSA12030-3-70-Y becomes:
2WSA12030-3-70-S when frequency range DC~3GHz, 0~70dB attenuation range in 1dB steps, average power 2W, SMA connectors, are desired.