

FEATURES

- ❑ Small Size
- ❑ High Accuracy
- ❑ High Stability
- ❑ Rugged Design

APPLICATIONS

- ❑ Wireless Communication
- ❑ Laboratory Test



Electrical Specifications

Frequency Range	DC~6GHz
Attenuation Range/Steps	0~70dB in 1dB steps
Attenuation Accuracy(dB)	±0.5 (Att. ≤10dB) ±0.8 (10dB < Att. < 60dB) ±1.5 (Att. ≥60dB)
VSWR	SMA: 1.55 max / N: 1.6 max
Insertion Loss	1.8 max.
Impedance	50 Ohms
Average Power	2W or 10W
Peak Power	100 Watts (5µs pulse width, 2% duty cycle)

Outline Drawings[mm]

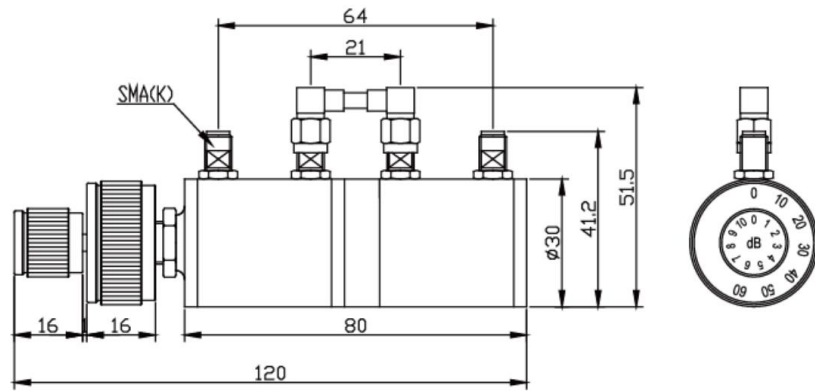

Mechanical Specifications

Connector	SMA or N
Connector Material	Brass Nickel Plated
Female Pin	Beryllium Copper, Gold Plated
Housing	Aluminum, Brass Nickel Plated
Temperature Range	-20°C ~ +85°C
Weight	435g
Size	120×Ø30mm exclusive of connectors
RoHS Status	RoHS Compliant

Ordering Information

XW	SA	12030	-	6	-	70	-	Y
Step Attenuator Attenuator Dimensions(mm) Max Frequency(GHz) Max Attenuation Value(dB) RF Connector S: SMA female to SMA female N: N female to N female Average Power ▷ options: 2W, 10W								

* XWSA12030-6-70-Y becomes:
10WSA12030-6-70-N when frequency range DC~6GHz, 0~70dB attenuation range in 1dB steps, average power 10W, N connectors, are desired.
 * XWSA12030-6-70-Y becomes:
2WSA12030-6-70-S when frequency range DC~6GHz, 0~70dB attenuation range in 1dB steps, average power 2W, SMA connectors, are desired.