

Product Features

- High RF performance and Competitive price
- Titan Microwave offers a standard product line of waveguide to coax adapters covering waveguide sizes WR10 thru WR2300
- This adaptor has been developed for laboratory and industrial applications up to 3 W at 50 GHz
- Rugged and Reliable
- Additional sizes and configurations available upon request

Outline Drawing[mm]

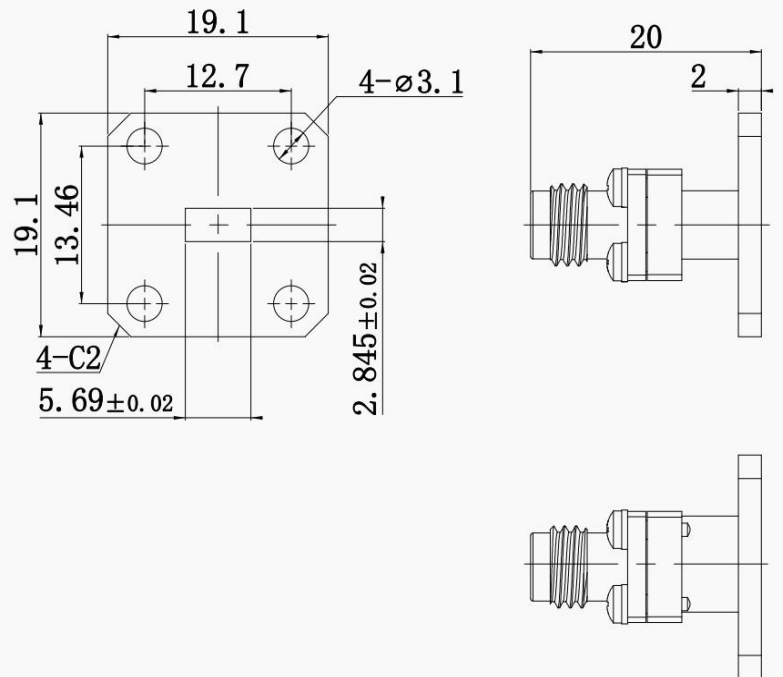

RF Characteristics	
Frequency Range	35000~45000 MHz
Insertion Loss	0.4dB max.
VSWR	1.2 max
Waveguide Connector	WR22(BJ400)
RF Connector	2.4mm female
Flange	FBP400
Maximum Power	3W in continuous wave(CW) 100W peak power
Material	Cu
Operating Temperature	-55°C ~ +85°C