

**SPECIFICATIONS**

Frequency Range:	DC~10GHz
Input Avg Power:	500W@25°C, 50W@125°C
Peak Power:	5kW(5μs pulse width, 10% duty cycle)
Impedance:	50 Ohms
Attenuation:	20-50dB
VSWR:	1.45 max.
Connector:	N-Male to N-Female
Operating Temp.:	-55°C~+125°C
Connector Body:	Nickel plated brass
Female Center Contact:	Gold plated beryllium copper
Male Center Contact:	Gold plated brass
Heat Sink:	Black anodized aluminum
Dimensions:	369×130×75mm
Weight	4500g
RoHS Status:	RoHS Compliant

**Maximum Deviation over Frequency**

Nominal ATTN(dB)	Frequency Range(GHz)			
	DC-4	DC-6	DC-8	DC-10
20	-	-	-	-
30	±0.5	-	-	-
40	±0.5	±0.75	±1.0	±1.2
50	±0.5	±0.75	±1.0	-1.0/+1.3
VSWR(max)	1.25	1.3	1.4	1.45

**Outline Drawing[mm]**



**Power/Temp Rating Curve**

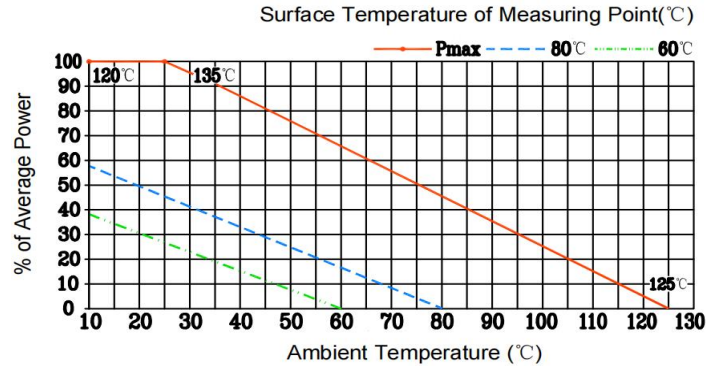

**Ordering Information**

TMFA10 X N 500 - XX

XX: Attenuation dB value

Average Power(W)

RF Connector

(N: N-Male to N-Female)

X: Maximum Frequency(GHz)

04: DC~4 GHz

10: DC~10 GHz

Titan Microwave Fixed Attenuator

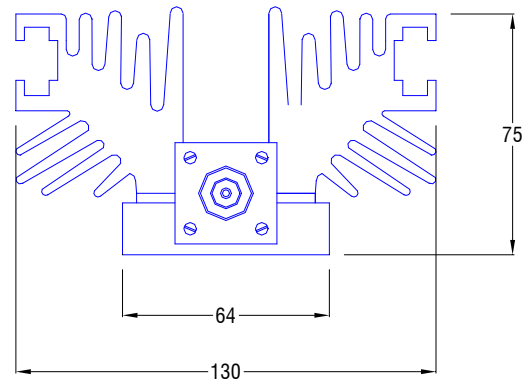

7/16 DIN connectors are available upon request.