

PART NUMBER
TMELC-VM

| REV. | DATE | COMMENTS | INITIAL |
|------|-----------|---------------------|---------|
| 1 | 2020/6/23 | ENGINEERING RELEASE | |

Specifications

| | |
|-----------------------|------------------------------|
| Frequency Range | DC-67GHz |
| Impedance | 50 Ohm |
| VSWR | 1.35 max |
| Operating Temperature | -55°C~+165°C |
| Durability(matings) | 500 Cycles |
| Body Width | 12.7mm |
| Pin Diameter | 0.007 inch |
| PCB Thickness | 2.5mm max |
| Connector Body | Stainless Steel, Passivated |
| Pin Contact | Gold Plated Beryllium Copper |
| Dielectric | PEI |
| Transition Block | Stainless Steel, Passivated |
| Launch Pin | Gold Plated Beryllium Copper |
| Block Dielectric | PTFE |

RoHS Compliant

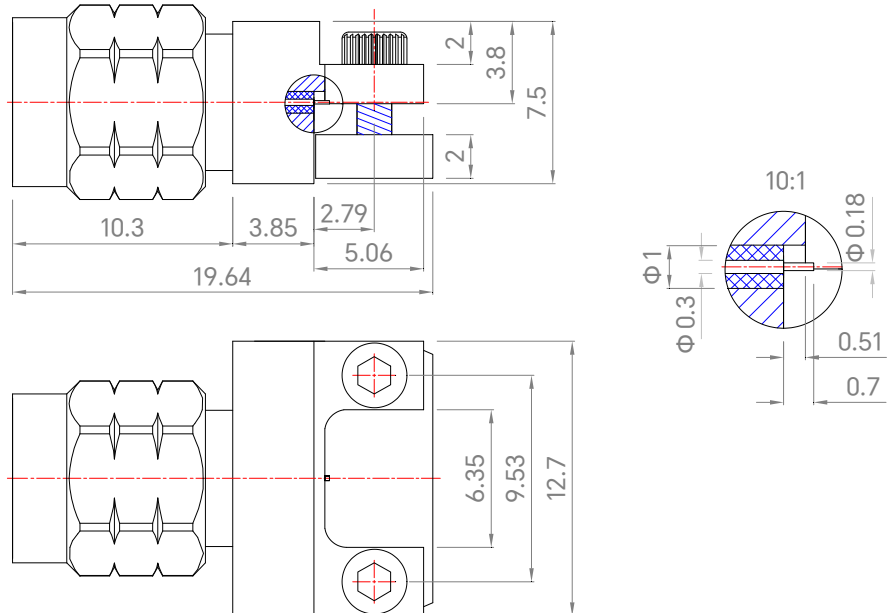

Drawing not to scale, units:mm[inch]



www.titan-microwave.com
Tel: +86 130 866 58398
Email: sales@titan-microwave.com
chris@titan-microwave.com

| | | |
|--|-----------|---|
| PART NUMBER TMELC-VM | | DESCRIPTION End Launch Connector, DC-67GHz 1.85mm-Male |
| CAGE CODE | SIGNATURE |  |
| EXCEPT AS OTHERWISE PROVIDED BY CONTRACTOR THIS DRAWING OR SPECIFICATION IS PROPERTY OF TITAN MICROWAVE INC. IT IS ISSUED IN STRICT CONFIDENCE AND SHALL NOT BE REPRODUCED OR USED AS THE BASIS. | | |