

PART NUMBER TMELC-KM-A	REV.	DATE	COMMENTS	INITIAL
	1	2020/6/23	ENGINEERING RELEASE	

Specifications

Frequency Range	DC-40GHz
Impedance	50 Ohm
VSWR	1.25 max
Operating Temperature	-55°C~+165°C
Durability(matings)	500 Cycles
Body Width	12.7mm
Pin Diameter	0.007 inch
PCB Thickness	2.5mm max
Connector	2.92mm-Male
Connector Body	Stainless Steel, Passivated
Pin Contact	Gold Plated Beryllium Copper
Dielectric	PEI
Transition Block	Stainless Steel, Passivated
Launch Pin	Gold Plated Beryllium Copper
Block Dielectric	PTFE

RoHS Compliant

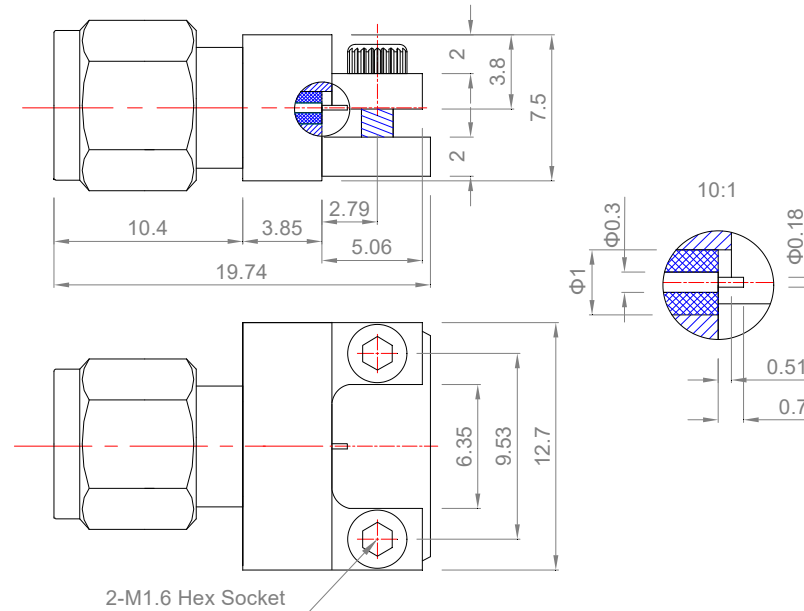

Drawing not to scale, units:mm



www.titan-microwave.com
 Tel: +86 130 866 58398
 Email: sales@titan-microwave.com
 chris@titan-microwave.com

PART NUMBER TMELC-KM-A		DESCRIPTION End Launch Connector, DC-40GHz 2.92mm-Male
CAGE CODE	SIGNATURE _____	
EXCEPT AS OTHERWISE PROVIDED BY CONTRACTOR THIS DRAWING OR SPECIFICATION IS PROPERTY OF TITAN MICROWAVE INC. IT IS ISSUED IN STRICT CONFIDENCE AND SHALL NOT BE REPRODUCED OR USED AS THE BASIS.		