

PART NUMBER <b>TMCI-24002410-20</b>	REV.	DATE	COMMENTS	INITIAL
	1	2021/6/25	ENGINEERING RELEASE	

**Specifications**

Frequency Range	24-24.1GHz
Impedance	50 Ohm
Insertion Loss	0.5dB max
VSWR	1.3 max
Isolation	18dB min
Forward Power(CW)	20W
Reverse Power	5W
Rotation	Clockwise
Connectors	2.92mm-Female
Temperature Range	-40°C~+85°C
Surface Finish	Nickel Plated
Case Material	Aluminum Alloy

**RoHS Compliant**

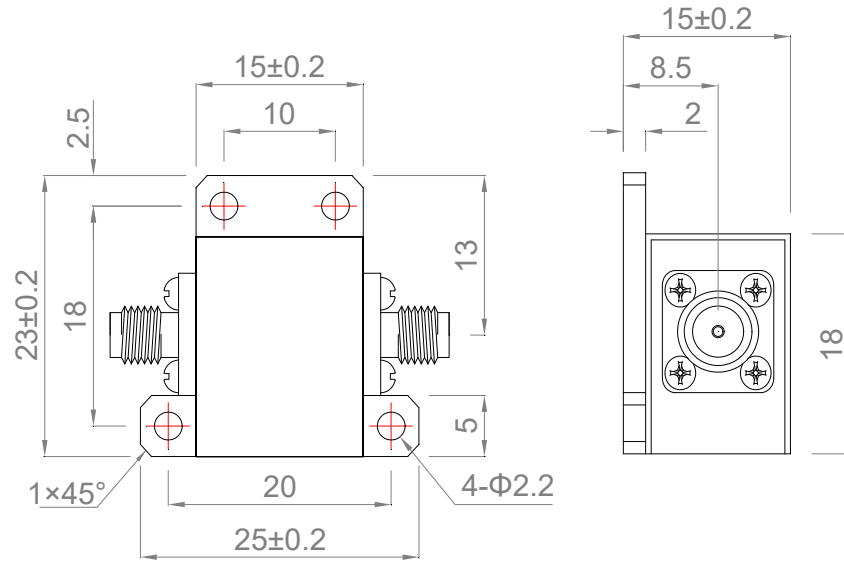

Drawing not to scale, units:mm



www.titan-microwave.com  
 Tel: +86 130 866 58398  
 Email: sales@titan-microwave.com  
 chris@titan-microwave.com

PART NUMBER <b>TMCI-24002410-20</b>		DESCRIPTION <b>Coaxial Isolator, 24-24.1GHz, 20W 2.92mm-Female</b>
CAGE CODE	SIGNATURE	
EXCEPT AS OTHERWISE PROVIDED BY CONTRACTOR THIS DRAWING OR SPECIFICATION IS PROPERTY OF TITAN MICROWAVE INC. IT IS ISSUED IN STRICT CONFIDENCE AND SHALL NOT BE REPRODUCED OR USED AS THE BASIS.		