

PART NUMBER
TMWC28-26504000-P25W

REV.	DATE	COMMENTS	INITIAL
1	2020/9/21	ENGINEERING RELEASE	

Specifications

Frequency Range 26.5-40GHz
 Insertion Loss 0.45dB max
 VSWR 1.4:1 max
 Isolation 16dB min
 Forward Power 25W
 Reverse Power 25W
 Waveguide Type WR-28
 Operating Temperature -40°C~+80°C
 Storage Temperature -40°C~+85°C

RoHS Compliant

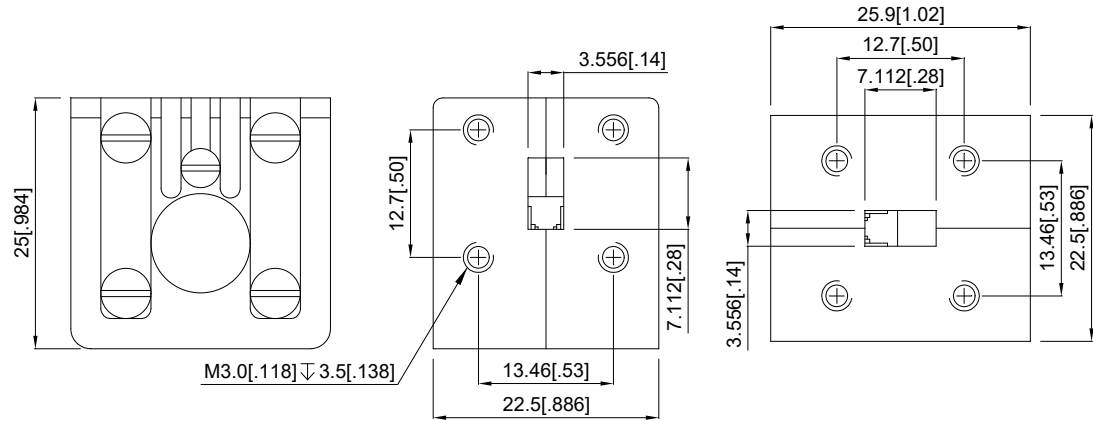

Drawing not to scale, units:mm[inches]



www.titan-microwave.com
 Tel: +86 130 866 58398
 Email: sales@titan-microwave.com
 chris@titan-microwave.com

PART NUMBER		DESCRIPTION
TMWC28-26504000-P25W		Waveguide Circulator, 26.5-40GHz WR-28, 25W
CAGE CODE	SIGNATURE	
	<i>Chris Chen</i>	
EXCEPT AS OTHERWISE PROVIDED BY CONTRACTOR THIS DRAWING OR SPECIFICATION IS PROPERTY OF TITAN MICROWAVE INC. IT IS ISSUED IN STRICT CONFIDENCE AND SHALL NOT BE REPRODUCED OR USED AS THE BASIS.		