

PART NUMBER TWDC28D40C10	REV.	DATE	COMMENTS	INITIAL
	1	2021/3/16	ENGINEERING RELEASE	

SPECIFICATIONS

RoHS Compliant

Frequency Range26.5-40GHz
 Coupling10±1.0dB
 Directivity 40dB min
 VSWR Primary 1.2:1 max
 VSWR Secondary 1.25:1 max
 Impedance 50 Ohms
 Waveguide Type WR-28
 Flange Type FBP320(UBR) Flange
 Waveguide Body Aluminum, Gray Painted
 Dimensions 150×19.1×19.1mm

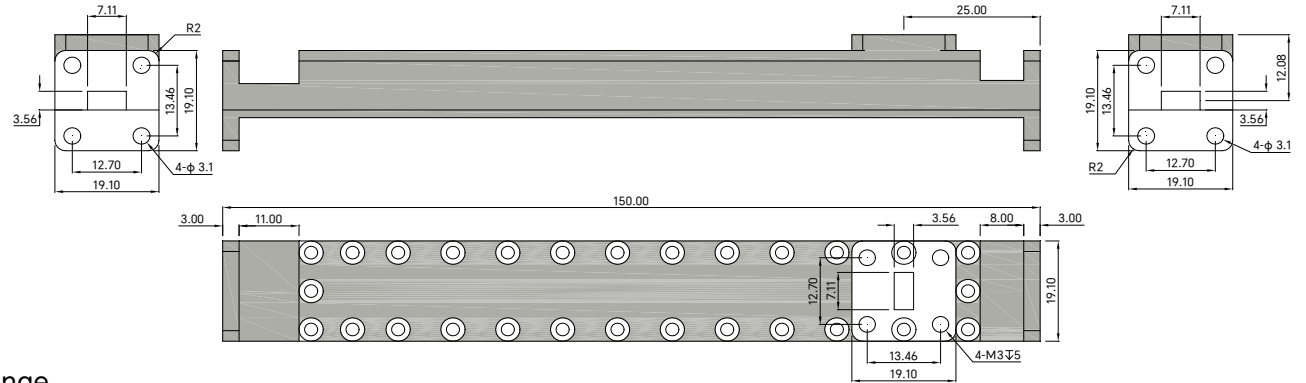

Drawing not to scale, units:mm



www.titan-microwave.com
 Tel: +86 185 8328 2993
 Email: sales@titan-microwave.com
 chris@titan-microwave.com

PART NUMBER TWDC28D40C10		DESCRIPTION Waveguide Directional Coupler, WR-28 26.5-40GHz, Coupling 10 ± 1.0dB
CAGE CODE	SIGNATURE	
EXCEPT AS OTHERWISE PROVIDED BY CONTRACTOR THIS DRAWING OR SPECIFICATION IS PROPERTY OF TITAN MICROWAVE INC. IT IS ISSUED IN STRICT CONFIDENCE AND SHALL NOT BE REPRODUCED OR USED AS THE BASIS.		