

PART NUMBER
TWDC90D30C40

| REV. | DATE | COMMENTS | INITIAL |
|------|-----------|---------------------|---------|
| 1 | 2021/4/25 | ENGINEERING RELEASE | |

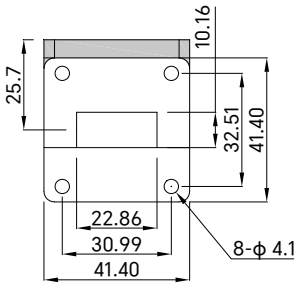

RoHS Compliant

Specifications

- Frequency Range8.6-10.6GHz
- Nominal Coupling 40±1.0dB
- Directivity 30dB min
- VSWR Primary 1.15:1 max
- VSWR Secondary 1.3:1 max
- Impedance 50 Ohms
- Waveguide Type WR-90
- Flange Type FBP100(UBR) Flange
- Operating Temperature -40°C~+85°C
- Waveguide Body Aluminum, Gray Painted
- Dimensions 200×41.4×41.4mm

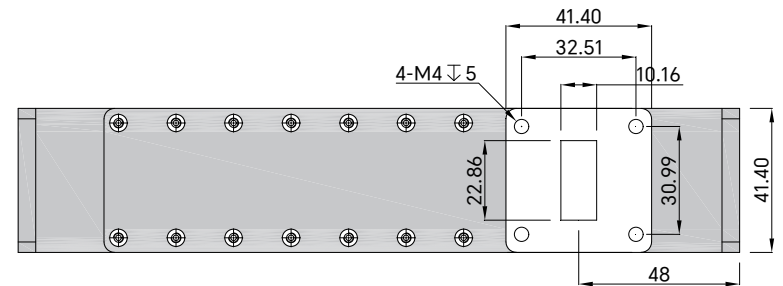
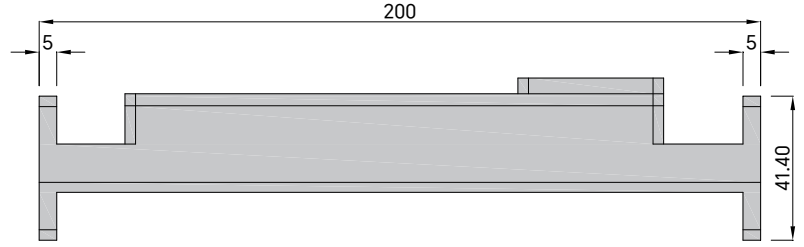

Drawing not to scale, units:mm



www.titan-microwave.com
Tel: +86 185 8328 2993
Email: sales@titan-microwave.com
chris@titan-microwave.com

| | | |
|--------------------------------------------------------------------------------------------------------------------------------------------------------------------------------------------------------------|--------------------|-----------------------------------------------------------------------------------------------------------|
| PART NUMBER TWDC90D30C40 | | DESCRIPTION Waveguide Broadwall Directional Coupler 8.6-10.6GHz, Coupling 40 ± 1.0dB, WR-90 |
| CAGE CODE | SIGNATURE _____ | |
| EXCEPT AS OTHERWISE PROVIDED BY CONTRACTOR THIS DRAWING OR SPECIFICATION IS PROPERTY OF TITAN MICROWAVE INC. IT IS ISSUED IN STRICT CONFIDENCE AND SHALL NOT BE REPRODUCED OR USED AS THE BASIS. | | |