

TMPD2-1M0100-2S

**1 to 1000 MHz, 2W, SMA-Female
2-WAY POWER DIVIDER**

Electrical Characteristics

Frequency Range 1~1000MHz
Insertion Loss 1.0dB max
 (excluding theoretical insertion loss 3.0dB)
Amplitude Balance ± 0.5 dB max
Phase Balance $\pm 6^\circ$ max
VSWR(input port) 1.3:1 max
VSWR(output ports) 1.3:1 max
Isolation 20dB min
Impedance 50 Ohms
Power Handling 2W

Outline Drawing(mm[inch])

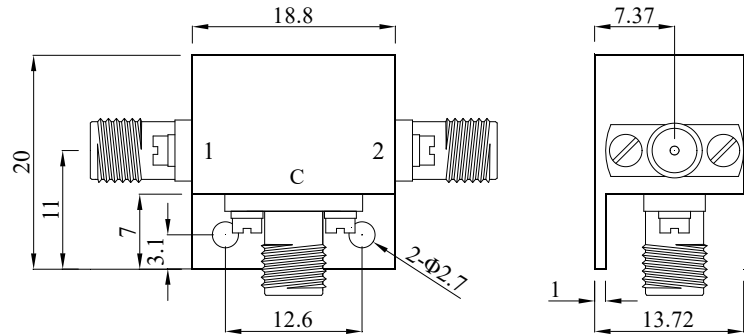

Mechanical & Environmental Characteristics

Dimensions 20 × 18.8 × 13.72mm
RF Connectors SMA-Female
Material Aluminum 6061
Operating Temperature -40°C~+85°C
Storage Temperature -50°C~+105°C