

REV	DESCRIPTION OF REVISION	By	DATE	APPROVED
A	INITIAL RELEASE	C. Dai	2023/2/11	C. Chen

## TECHNICAL DATA

### ► Electrical Data

Frequency Range	0.01-26.5GHz
Low Level Sensitivity	$\geq 0.5\text{mV}/\mu\text{W}$ @0.01-18GHz, $\geq 0.18\text{mV}/\mu\text{W}$ @18-26.5GHz
VSWR	$\leq 1.5$ @0.01-18GHz, $\leq 2.2$ @18-26.5GHz
Maximum Input Power	100mW(20dBm)
Maximum Flatness	$\pm 0.6\text{dB}$ @0.01-18GHz, $\pm 1.5\text{dB}$ @18-26.5GHz
Impedance	50 Ohms

### ► Mechanical Data

Input Connector	SMA-Male
Output Connector	SMA-Female
Body	Nickel Plated Brass
Outer Conductor	Nickel Plated Brass
Inner Conductor(male)	Gold Plated Brass
Inner Conductor(female)	Gold plated beryllium copper

### ► Environmental Data

Operating Temperature	-20°C~+55°C
Storage Temperature	-45°C~+85°C

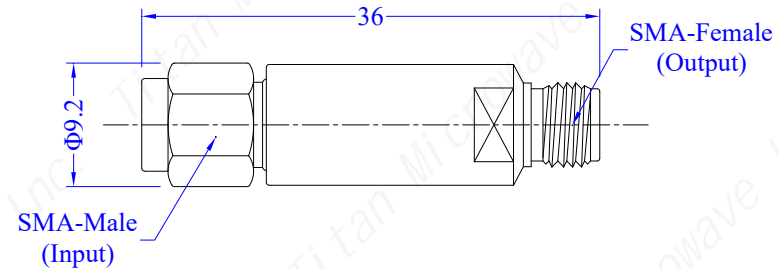

★ Negative output polarity standard. Add "P" to end of model number for positive output polarity.

#### Notes:

- ALL SPECIFICATIONS ARE SUBJECT TO CHANGE WITHOUT NOTICE AT ANY TIME
- CUSTOMER OUTLINE DRAWING FOR REFERENCE ONLY

DRAWN: L. Ma 11/02/23		
ENGINEER: J. Zhu 11/02/23		
APPROVED: C. Chen 11/02/23		
TOLERANCE UNLESS OTHERWISE SPECIFIED		
x	±0.50	[0.019"]
.x	±0.20	[0.008"]
.xx	±0.10	[0.004"]
ANGLES	±1°	

**TITLE:**  
Coaxial Detector, 0.01-26.5GHz, Input Power 100mW max, VSWR 2.2 max, Negative Polarity

**PART No.:**  
TMDT-0126-SMA



[www.titan-microwave.com](http://www.titan-microwave.com)

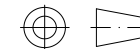

DIMENSIONS IN MILLIMETERS(mm)

<b>SIZE:</b> A4	<b>SCALE:</b>	<b>SHEET:</b> 1/1	<b>REV:</b> A
--------------------	---------------	----------------------	------------------