

REV	DESCRIPTION OF REVISION	By	DATE	APPROVED
A	INITIAL RELEASE	C. Cai	2023/5/18	C. Chen

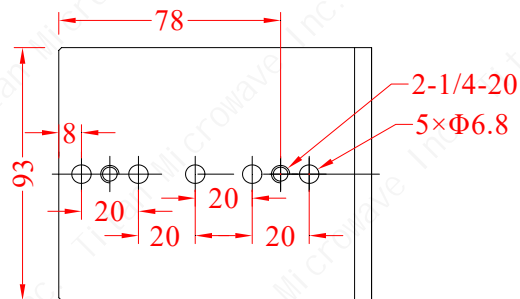
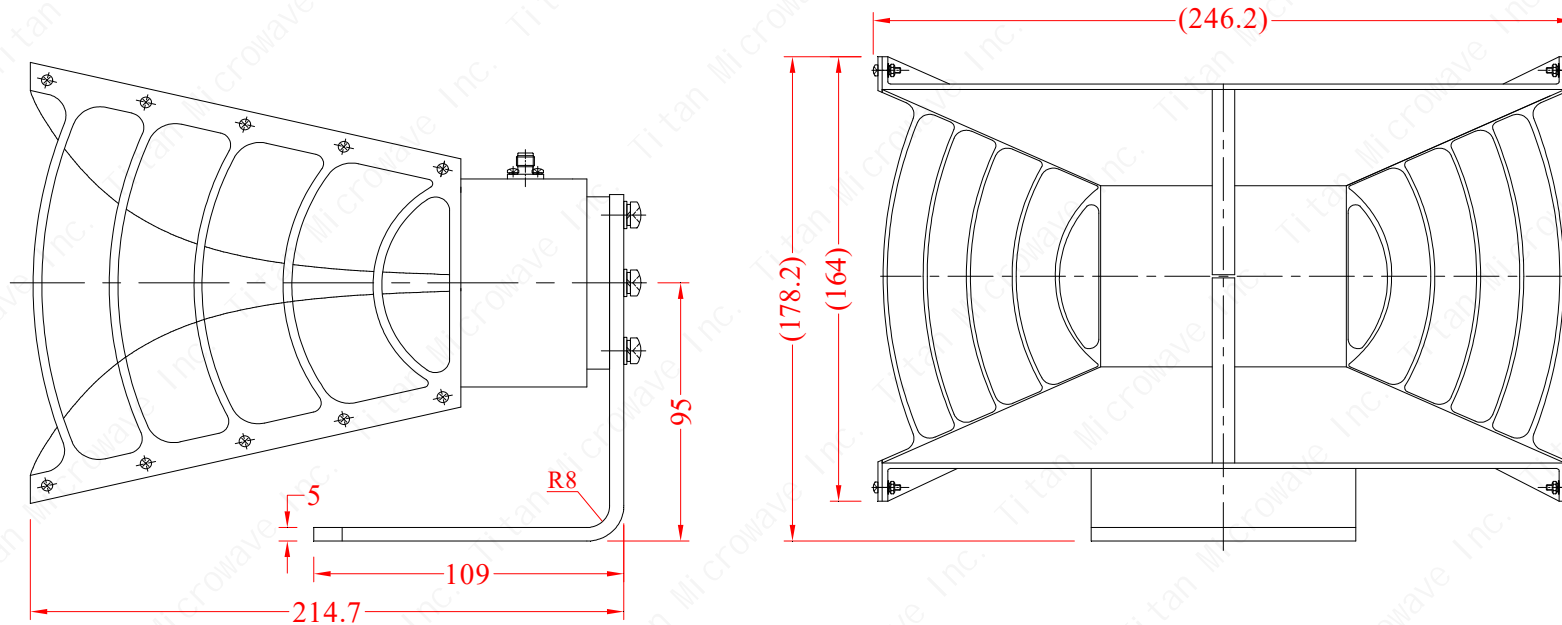

Frequency Range: 1~20GHz
 VSWR \leq 2~2.5
 Gain: 10dBi typical
 RF Connector: SMA-Female
 Material: Aluminum
 Surface Finish: Conductive Oxidation
 Size: 246×164×215mm
 Weight: 1.8kg

Notes:

1. ALL SPECIFICATIONS ARE SUBJECT TO CHANGE WITHOUT NOTICE AT ANY TIME
2. CUSTOMER OUTLINE DRAWING FOR REFERENCE ONLY

DRAWN: L. Ma 18/05/23		
ENGINEER: J. Zhu 18/05/23		
APPROVED: C. Chen 18/05/23		
TOLERANCE UNLESS OTHERWISE SPECIFIED		
x	±0.50	[0.019"]
.x	±0.20	[0.008"]
.xx	±0.10	[0.004"]
ANGLES	±1°	

TITLE:
 Double Ridged Broadband
 Horn Antenna, 1-20GHz,
 Gain 10dBi typ, SMA-
 Female

PART No.:
 TMBDHA-01002000-10S



www.titan-microwave.com



DIMENSIONS IN MILLIMETERS(mm)

SIZE: A4	SCALE:	SHEET: 1/1	REV: A
-------------	--------	---------------	-----------