

REV	DESCRIPTION OF REVISION	By	DATE	APPROVED
A	INITIAL RELEASE	C. Cai	2022/8/10	C. Chen

## TECHNICAL DATA

### ► Electrical Data

Frequency Range	2000~8000MHz
Insertion Loss	0.5dB max
VSWR	1.35:1 max
Isolation	18dB min
Phase Balance	±5° max
Amplitude Balance	±0.7dB
Power Handling	150W

### ► Mechanical Data

Dimensions	48×25×11mm
Connector Type	Stripline
Surface Finish	Conductive Oxidation

### ► Environmental Data

Operating Temperature	-55℃~+85℃
-----------------------	-----------

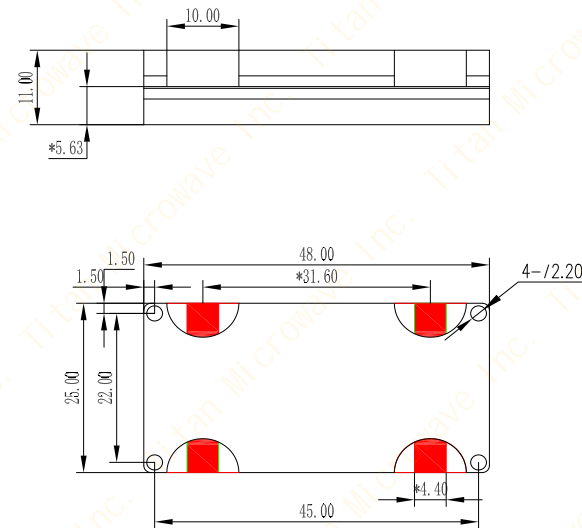

DRAWN: L. Ma 10/08/22		
ENGINEER: J. Zhu 10/08/22		
APPROVED: C. Chen 10/08/22		
TOLERANCE UNLESS OTHERWISE SPECIFIED		
x	±0.50	[0.019"]
.x	±0.20	[0.008"]
.xx	±0.10	[0.004"]
ANGLES	±1°	

**TITLE:**  
SMD 90 Degree Hybrid  
Coupler, 3dB, 2-8GHz,  
150W

**PART No.:**  
TM0123-3

**成都巨人微波**  
**TITAN MICROWAVE INC.**  
- A Professional RF & Microwave Components Supplier -

[www.titan-microwave.com](http://www.titan-microwave.com)



DIMENSIONS IN MILLIMETERS(mm)

SIZE: A4	SCALE:	SHEET: 1/1	REV: A
-------------	--------	---------------	-----------

**Notes:**

- ALL SPECIFICATIONS ARE SUBJECT TO CHANGE WITHOUT NOTICE AT ANY TIME
- CUSTOMER OUTLINE DRAWING FOR REFERENCE ONLY