

REV	DESCRIPTION OF REVISION	By	DATE	APPROVED
A	INITIAL RELEASE	C. Cai	2025/4/30	C. Chen

TECHNICAL DATA

► Electrical Data

Frequency Range	10KHz~100MHz
Coupling	50±1.5dB
Coupling Flatness	±1.2dB max
Insertion Loss	0.5dB max
Primary Line VSWR	1.3:1 max
Directivity	16dB min
Impedance	50 Ohms
Primary Line Power	500W(CW)

► Mechanical Data

Primary Line Connectors	N-Female
Coupled Connectors	SMA-Female
Housing Material	Aluminum
Surface Finish	Conductive Oxidation
Dimensions	120×55.9×30mm

► Environmental Data

Operating Temperature	-55℃~+85℃
-----------------------	-----------

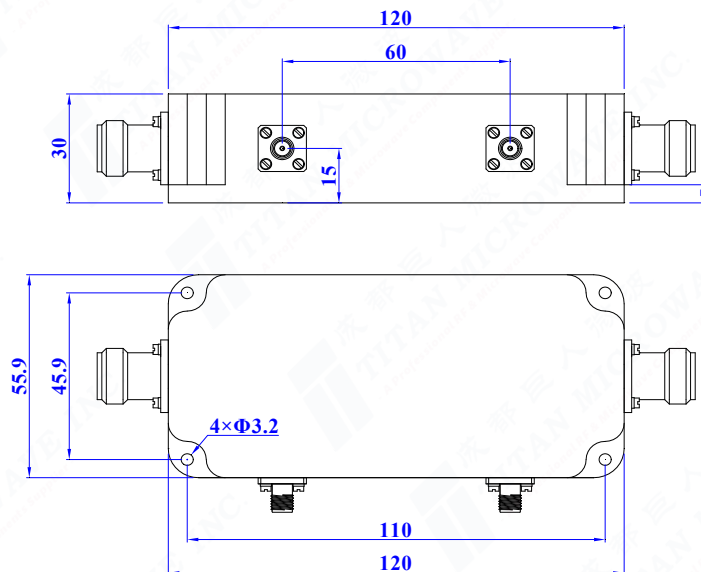

Notes:

- ALL SPECIFICATIONS ARE SUBJECT TO CHANGE WITHOUT NOTICE AT ANY TIME
- CUSTOMER OUTLINE DRAWING FOR REFERENCE ONLY

DRAWN: L. Ma 30/04/25
ENGINEER: J. Zhu 30/04/25
APPROVED: C. Chen 30/04/25
TOLERANCE UNLESS OTHERWISE SPECIFIED
x ±0.50 [0.019"]
.x ±0.20 [0.008"]
.xx ±0.10 [0.004"]
ANGLES ±1°

TITLE:

Dual Directional Coupler,
10KHz~100MHz, 50dB,
500W, N-Female &
SMA-Female

PART No.:

TDDC-10K100M-50NS500



www.titan-microwave.com



DIMENSIONS IN MILLIMETERS(mm)

SIZE: A4	SCALE:	SHEET: 1/1	REV: A
-------------	--------	---------------	-----------